

MB20C

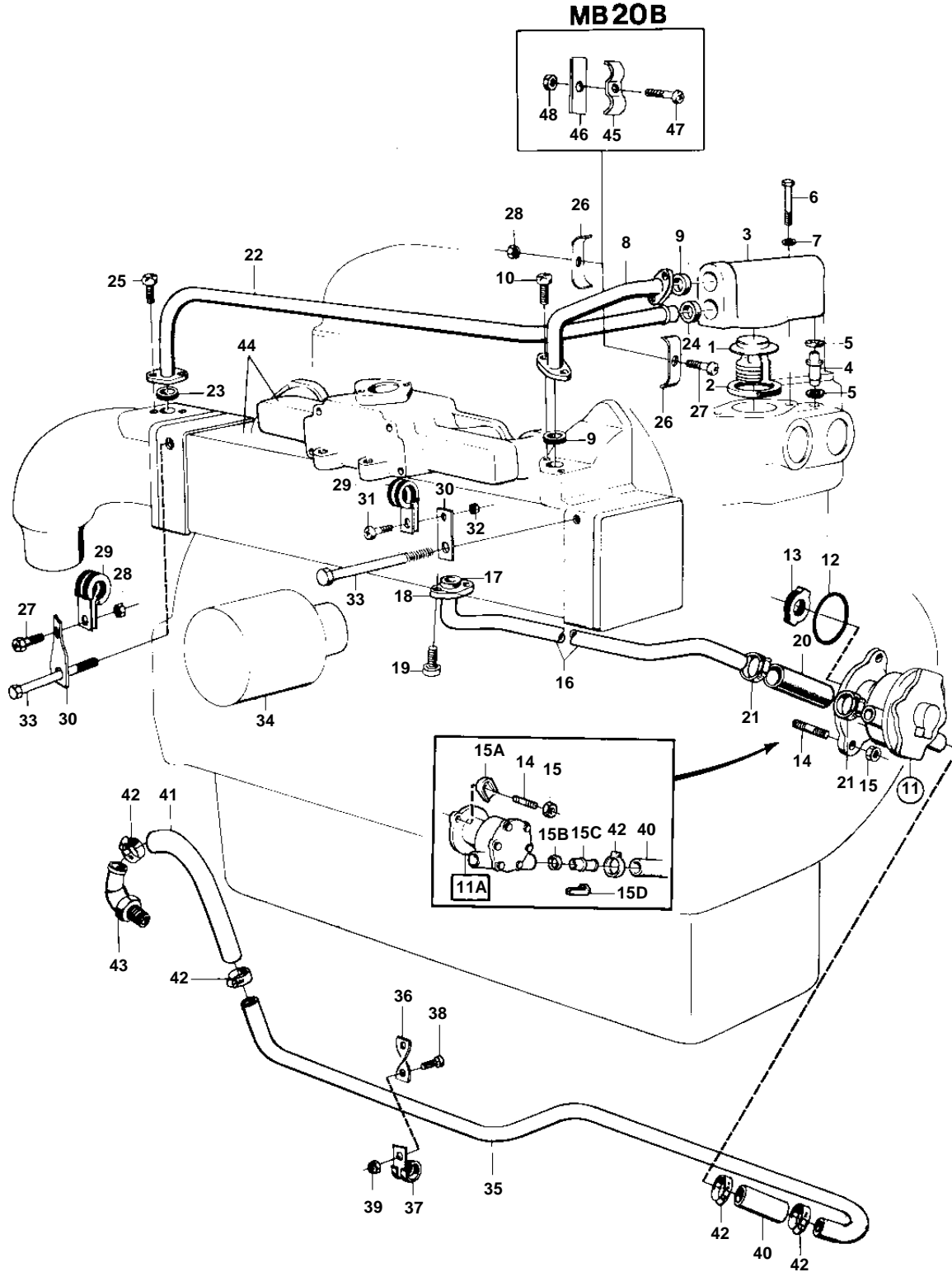

6353

MB20C

| REF | PART NO. | QTY | DESCRIPTION | SEE SEC. | NOTES |
|-----|----------|-----|--|----------|--|
| 1 | 829813 | 1 | Thermostat | | (824833) |
| 2 | 416033 | 1 | Sealing ring | | (418361) |
| 3 | | 1 | Thermostat housing | | |
| 4 | 806215 | 1 | Tube | | |
| 5 | 829714 | 2 | Sealing ring | | |
| 6 | 955528 | 2 | Hexagon screw | | |
| 7 | 120265 | 2 | Washer | | |
| 8 | | 1 | Coolant pipe | | |
| 9 | 418445 | 2 | Sealing ring | | |
| 10 | 950046 | 4 | Cross recessed screw | | |
| 11 | 825916 | 1 | Water pump, COOLING WATER PUMP COOLING WATER PUMP | | SHAFT AND SPACER RING 910396 REPLACES EARLY TYPE WITHOUT SPACER RING |
| 11A | 829895 | 1 | Sea water pump | | |
| 12 | 925091 | 1 | O-ring | | |
| 13 | 806256 | 1 | Companion flange | | |
| 14 | | 2 | Stud | | |
| 15 | 950352 | 2 | Lock nut | | |
| 15A | 833878 | 2 | Clamp | | REPLACED BY 1EA 4804105, 1EA 350578. |
| 15B | 418411 | 2 | Sealing ring | | REPLACED BY 1EA 4804105, 1EA 350578. |
| 15C | 829901 | 2 | Connection pipe | | REPLACED BY 1EA 4804105, 1EA 350578. |
| 15D | 829898 | 2 | Clamp | | REPLACED BY 1EA 4804105, 1EA 350578. |
| 16 | | 1 | Coolant pipe | | |
| 17 | 418445 | 1 | Sealing ring | | |
| 18 | | 1 | Flange | | |
| 19 | 950046 | 2 | Cross recessed screw | | |
| 20 | 952969 | 1 | Hose | | L = 55 MM |
| 21 | 943473 | 2 | Hose clamp | | (951789) |
| 22 | 824673 | 1 | Pipe | | |
| 23 | 418445 | 1 | Sealing ring | | |
| 24 | 418411 | 1 | Sealing ring | | |
| 25 | 950046 | 2 | Cross recessed screw | | |
| 29 | 952629 | 2 | Clamp | | |
| 30 | | 2 | Anchorage | | |
| 31 | 950047 | 2 | Cross recessed screw | | |
| 32 | 950352 | 2 | Lock nut | | |
| 33 | 959793 | 2 | Hexagon screw | 12786 | |
| 34 | 1266286 | 1 | Oil filter | | SEE GROUP 2A |
| 35 | | 1 | Coolant pipe | | SPEC.9969, 867113. |
| 36 | | 1 | Anchorage | | SPEC.9969, 867113. |
| 37 | 952631 | 1 | Clamp | | SPEC.9969, 867113. |
| 38 | 950046 | 1 | Cross recessed screw | | SPEC.9969, 867113. |
| 39 | 950352 | 1 | Lock nut | | SPEC.9969, 867113. |
| 40 | 943368 | X | Rubber hose | | SPEC.9969, 867113., L = 50 MM |
| 41 | 943368 | X | Rubber hose | | SPEC.9969, 867113., L = 225 MM |
| 42 | 943472 | 4 | Hose clamp | | SPEC.9969, 867113. |
| 43 | 804429 | 1 | Hose attachment | | SEE GROUP 4A |
| 44 | | | | | |
| 48 | 828065 | 1 | Muffler, EXHAUST MUFFLER | | SEE GROUP 9 |
| | | 1 | WATER COOLED EXHAUST LINE | | SEE GROUP 9 |